

DRAFT AMENDMENT NO. 2 MAY 2024

TO

IS 17509 : 2021 DISPOSABLE BABY DIAPER — SPECIFICATION

(Not to be reproduced without the prior permission of BIS or used as amendment to the standard)

(Page 1, clause 6.1) — Substitute the following for the existing:

‘6.1 On the basis on the weight of premature baby, infant and/or toddler, the baby diapers are classified in the following types:

Category	Weight of the premature baby, infant and or toddler
Premature Baby	Up to 2 kg
New Born	2 – 5 kg
Small	3 – 8 kg
Medium	6 – 11 kg
Large	9 – 11 kg
X Large	13 + kg
XX Large	15 – 25 kg
XXX Large	17 + kg

The weight of baby diaper may vary between different types as per the agreement between the buyer and the seller.’

(Page 2, clause 6.2, Table 1) — Substitute the following for the existing:

‘6.2 The dimensions of the diaper shall ensure proper and comfortable fit for the baby. The dimension may vary between different types and sizes of the diapers or as per the agreement between buyer and seller. The recommended dimensions of baby diaper are given in Table 1 (see Fig 1):

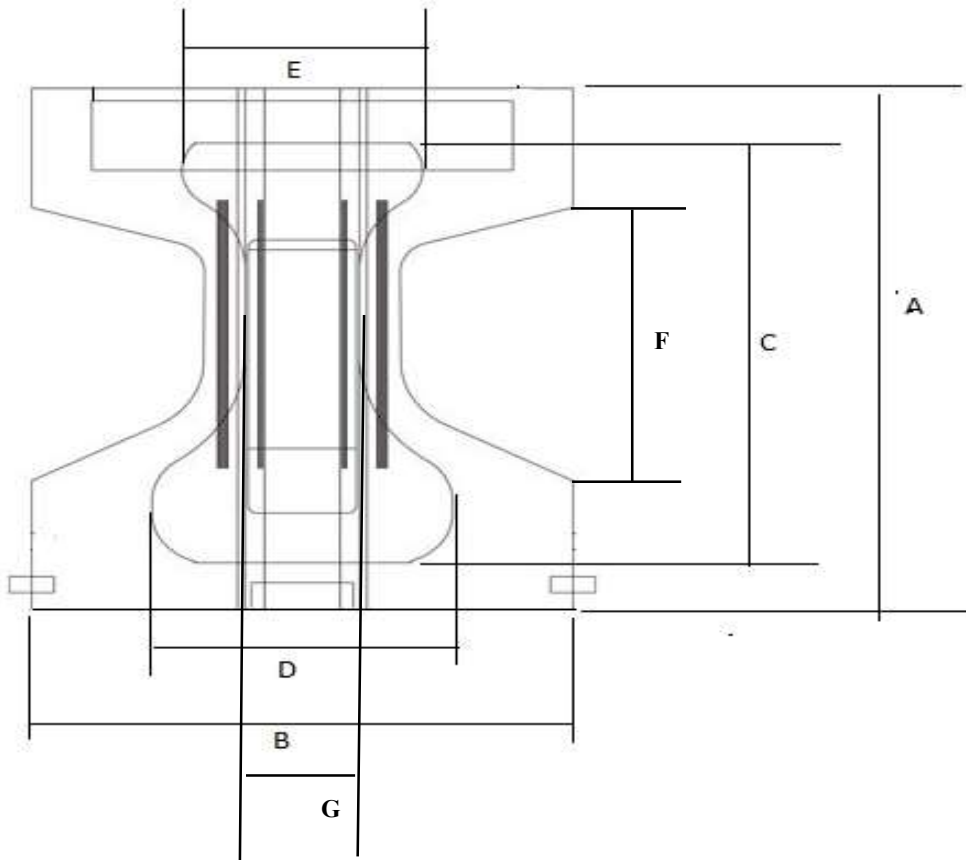

FIG. 1 SCHEMATIC SHOWING SIZE OF BABY DIAPER (FOR REFERENCE ONLY)

Table 1 Dimensions of Baby Diaper (mm)

(For reference only)

(Clause 6.2)

Size	Diaper Length (A)	Diaper Width (B)	Absorbent core Length (C)	Absorbent core width back (D)	Absorbent core width front (E)	Diaper Crotch (F)	Core Crotch (G)
Premature Baby	320 ± 10	250 ± 05	260 ± 10	100 ± 10	100 ± 10	185 ± 10	80 ± 05
New Born	350 ± 10	260 ± 05	285 ± 10	110 ± 10	110 ± 10	195 ± 10	85 ± 05
Small	390 ± 10	260 ± 05	300 ± 10	110 ± 10	110 ± 10	195 ± 10	85 ± 05
Medium	440 ± 10	310 ± 05	340 ± 10	110 ± 10	110 ± 10	195 ± 10	85 ± 05
Large	480 ± 10	310 ± 05	370 ± 10	110 ± 10	110 ± 10	215 ± 10	85 ± 05
X Large	520 ± 20	310 ± 05	370 ± 10	110 ± 10	110 ± 10	215 ± 10	85 ± 05
XX Large	560 ± 20	420 ± 05	380 ± 10	110 ± 10	110 ± 10	250 ± 10	80 ± 05
XXX Large	580 ± 10	440 ± 10	410 ± 10	125 ± 10	125 ± 10	250 ± 10	125 ± 10

Note — The recommended dimension and tolerance (for reference) for premature baby and other variety not covered in Table 1 shall be declared by the manufacture.

(Page 2, clause 7.2, Table 2) — Substitute the following for the existing:

Table 2 Requirement of Disposable Baby Diaper

(Clause 7.2)

	Size	Number of Gushes	Requirement
Minimum absorption capacity	Premature baby	3	3 x 10 ml
	New born	3	3 x 20 ml
	Small	3	3 x 35 ml
	Medium	3	3 x 50 ml
	Large	3	3 x 60 ml
	X Large	3	3 x 70 ml
	XX Large	3	3 x 75 ml
	XXX Large	3	3 x 75 ml
	Rate of absorption per gush (s), <i>Max</i>	All sizes	-
Rewet under load, (gm), <i>Max</i>	All sizes	-	5

(Page 6, clause B-2.2, second sentence) — Substitute the following for the existing:

‘The dimensions of the plate shall be around 200 mm × 70 mm and inner diameter of cylinder shall be 40 mm (premature baby, new born, small) (see Fig. 4), 50 mm (medium, large) and 60 mm (X Large, XX Large and XXX Large).’