

BUREAU OF INDIAN STANDARDS

DRAFT FOR COMMENTS ONLY

(Not to be reproduced without the permission of BIS or used as an Indian Standard)

भारतीय मानक मसौदा

घरेलू प्रयोजनों के लिए सिलाई मशीनों के लिए स्लाइड प्लेट —विशिष्ट

(आई एस 12058 का पहला पुनरीक्षण)

Draft Indian Standard

**SLIDE PLATES FOR SEWING MACHINES
FOR HOUSEHOLD PURPOSES — SPECIFICATION**

(First Revision of IS 12058)

ICS 61.080

Sewing Machine Sectional
Committee, MED 29

Last date for receipt of
comments is **07 January 2024**

FOREWORD

(Formal clauses to be added later)

This standard has been prepared to verify and rationalize the types and sizes of sewing machines components for manufacturing in economic quantities.

This standard was first published in 1987. The first revision has been taken up for incorporating the modifications found necessary as a result of experience gained with the use of this standard. Also, in this revision, the standard has been brought into the latest style and format of Indian Standards, and references wherever applicable have been updated. The BIS certification marking clause has been modified to align with the revised *Bureau of Indian Standards Act, 2016*.

For the purpose of deciding whether a particular requirement of this standard is complied with, the final value, observed or calculated, expressing the result of a test shall be rounded off in accordance with IS 2 : 2022 'Rules for rounding off numerical values (*second revision*)'. The number of significant places retained in the rounded-off value should be the same as that of the specified value in this standard.

1 SCOPE

Lays down requirements for slide plates for sewing machines for household purposes.

2 REFERENCES

The standards listed below contain provisions which, through their references in the text, constitute the provision of this standard. At the time of publication, editions indicated were valid. All standards are subject to revision and parties to the agreement based on this standard are encouraged to investigate the possibility of applying the most recent editions of the standards indicated below:

<i>IS No.</i>	<i>Title</i>
IS 513 : 2016	Cold reduced low carbon steel sheets and strips (<i>sixth revision</i>)
IS 2500 (Part 1) : 2000	Sampling procedures for inspection by attributes: Part 1 sampling schemes indexed by acceptance quality limit (AQL) for lot - By - Lot inspection (<i>third revision</i>)

3 MATERIAL

The slide plate shall be made from steel sheet conforming to grade ‘O’ of IS 513.

4 DIMENSIONS AND TOLERANCES

Shall be as shown in Fig. 1.

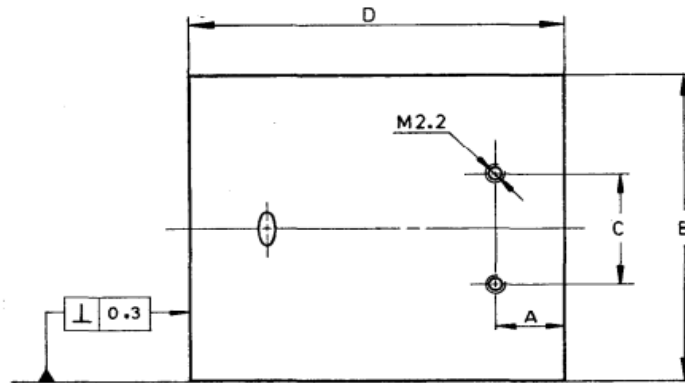

All dimensions in millimeters.

	A	B	C	D
Type A	13.13 ⁰ _{-0.26}	63.90 ⁰ _{-0.20}	23.08 ⁰ _{-0.16}	73.20 ⁰ _{-0.40}
Type B	12.83 ⁰ _{-0.26}	63.50 ⁰ _{-0.20}	22.94 ⁰ _{-0.16}	71.35 ⁰ _{-0.40}

FIG. 1 DIMENSIONS FOR SLIDE PLATE FOR SEWING MACHINE

5 CONSTRUCTION AND FUNCTIONS

- 5.1 Play of slide plate shall be at a minimum when fitted to bed.
- 5.2 Surfaces of the slide plate shall not project above the surface of the needle plate.
- 5.3 The edges of the top surfaces shall be smoothly chamfered.
- 5.4 Slide plate spring shall function properly.

6 WORKMANSHIP AND FINISH

- 6.1 The slide plate shall be of superior finish, free from cracks, flaws burrs and rust.
- 6.2 The slide plate shall be nickel-chrome plated in accordance with IS 1068 'Electroplated coating nickel plus chromium and copper plus nickel plus chromium on iron and steel (second revision)'.
 - 6.2.1 The thickness of plating shall conform to service grade 3.
- 6.3 Plated surface shall be smooth and allow smooth feeding of fabrics.
 - 6.3.1 Colour and lustre of plated surface shall be satisfactory and free from unevenness.

7 MARKING

The slide plate shall be marked with the manufacturer's name or trade-mark, if required.

7.1 BIS Certification Marking

The Slide plates may also be marked with Standard Mark.

7.1.1 The product(s) conforming to the requirements of this standard may be certified as per the conformity assessment schemes under the provisions of the *Bureau of Indian Standards Act, 2016* and the Rules and Regulations framed thereunder, and the products may be marked with the Standard Mark.

8 PACKING

Each slide plate shall be given a suitable anti-rust coating. The wrapped slide plates shall be securely packed in accordance with best prevalent trade practice. Each package shall bear the manufacturer's name, trade-mark and the description of contents.

9 SAMPLING

9.1 Unless otherwise agreed to between the supplier and the purchaser, the sampling plan as given in Annex A shall be followed. For further information, reference may be made to IS 2500 (Part 1).

ANNEX A

(Clause 9)

SCALE OF SAMPLING AND CRITERIA FOR CONFORMITY

A-1 SCALE OF SAMPLING

A-1.1 Lot

In any consignment, all the slide plates of the same type and manufactured from the same material under essentially similar conditions of manufacture shall be grouped together to constitute a lot.

A-1.2 For ascertaining the conformity of the lot to the requirements of specification, tests shall be carried out for each lot separately. The number of slide plates to be selected at random for this purpose shall be in accordance with col 1 and 2 of Table 1.

Table 1 Scale of Sampling and Permissible Number of Defectives <i>(Clauses A-1.2, A-1.4 and A-2.1)</i>			
Sl. No.	Number of Slide Plate N	For Dimensions, Tolerances, Workmanship and Finish	
		Sample Size n	Permissible Number of Defectives*
(1)	(2)	(3)	(4)
i)	Up to 15	5	0
ii)	16 to 40	8	0
iii)	41 to 110	13	0
iv)	111 to 300	20	1
v)	301 to 500	32	1
vi)	501 to 800	50	2
vii)	801 to 1 300	80	3
viii)	1 301 and above	125	5

* This ensures that lots containing only 1.5 percent or if less defectives shall be accepted most of the time.

A-1.3 If the slide plates are packed individually, in order to ensure the randomness of selection, IS 4905 shall be used.

A-1.4 If the slide plates are packed in different cartons, a suitable number of cartons (not less than 20 percent of the total in the lot subject to a minimum of 2) shall be chosen at random. From each of the cartons so chosen, an approximately equal number of slide plates shall be picked up from its different parts so as to obtain the required number of slide plate specified in col 2 of Table 1.

A-2 NUMBER OF TESTS AND CRITERIA FOR CONFORMITY

A-2.1 The slide plates selected according to **A-1.2** and **A-1.3** or **A-1.4** shall be examined for dimensions and tolerances (*see 3*), and workmanship (*see 5*). If the number of slide plates failing

to meet one or more of the requirements mentioned above is less than or equal to the permissible number of defectives given in col 3 of Table 1, the lot shall be declared as conforming to the requirements of these characteristics.