

BUREAU OF INDIAN STANDARDS

DRAFT FOR COMMENTS ONLY

(Not to be reproduced without the permission of BIS or used as an Indian Standard)

भारतीय मानक मसौदा

पावर टिलर के लिए हिच – आयाम

(आइ एस 10747 का पहला पुनरीक्षण)

Draft Indian Standard

HITCH FOR POWER TILLER — DIMENSIONS

(First Revision of IS 10747)

ICS 65.060.01

Agricultural Machinery and Equipment
Sectional Committee, FAD 11

Last date for Comments: **18 November 2024**

FOREWORD

(Formal clause will be added later)

The standard was published in 1983 deriving assistance from JIS B 9209 “Dimensions of hitch for walking tractors”, issued by the Japanese Industrial Standards Committee.

The first revision of the standard has been undertaken to incorporate necessary editorial changes and to bring it out in the latest style and format of Indian Standards.

For the purpose of deciding whether a particular requirement of this standard is complied with the final value, observed or calculated, expressing the result of a test or analysis, shall be rounded off in accordance with IS 2: 2022 ‘Rules for rounding off numerical values’ (*second revision*). The number of significant places retained in the rounded off value should be the same as that of the specified value in this standard.

Draft Indian Standard
HITCH FOR POWER TILLER — DIMENSIONS
(First Revision)

1 SCOPE

The standard covers the main dimensions of the hitch for power tillers.

2 DIMENSIONS

The main dimensions of the hitch for power tillers shall be as given in Fig. 1. The pin hole diameter (*see A* in Fig. 1) shall be 20 mm.

NOTE — Ample space shall be provided above the hitch so that the insertion of the pin is not obstructed. The diameter of the pin shall be 19 mm.

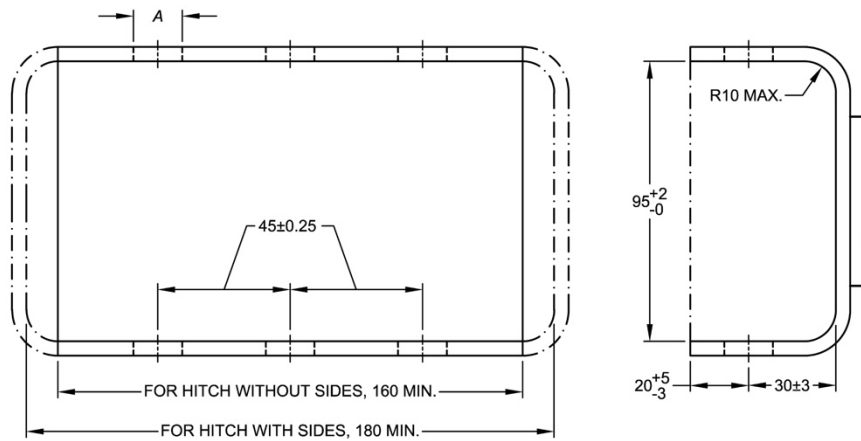

All dimensions in millimetres
FIG. 1 HITCH FOR POWER TILLERS